

# AHP-150FF Air Conditioner

Air Cooled  
Thru Mount  
NEMA-12  
NEMA-4

General Purpose VDC Input

## FEATURES

- Compact (only 7" L X 5" W X 6.02" D)
- Weighs only 3.2 lbs. (1.5 kg)
- Ambient range -10°C to +70°C
- No compressor, fluorocarbons or filters
- Virtually maintenance-free operation
- Mounts in any orientation

## INCLUDES

- Mounting gasket
- Hook-up leads
- Mounting Hardware

## OPTIONS

- Temperature control TC-6F DC for cool only
- Temperature control TC-3F DC for heat/cool
- Temperature Control TC-3500 for heat/cool reverse polarity
- Adaptable for TC-3300 and TC-4300 controller



## SPECIFICATIONS

	MODEL	PART NUMBER	NOTES	PERFORMANCE RATING	VOLTAGE VDC BTU/HR	CURRENT AMPS. *	WEIGHT LBS.(KG)	TEMP. CONTROL	OPERATING AMBIENT °C
N 12	AHP-150FF	0-8098-0-000	Cool only	90-105	12/24	6/3	3.2(1.5)	none	-10/+70
	AHP-150FFHC	0-8094-1-000	Heat/Cool	90-105	12	6	3.2(1.5)	none	-10/+70
	AHP-150FFHC	0-8095-1-000	Heat/Cool	90-105	24	3	3.2(1.5)	none	-10/+70
N 4	AHP-150FFHC	0-8098-1-001	Heat/Cool rev. pol.	90-105	12/24	6/3	3.2(1.5)	none*	-10/+70
	AHP-150XE	0-8094-4-000	Cool only	90-105	12	6	3.2(1.5)	none	-10/+70
	AHP-150XEHC	0-8094-5-000	Heat/Cool	90-105	12	6	3.2(1.5)	none	-10/+70
	AHP-150XEHC	0-8094-5-001	Heat/Cool rev. pol.	90-105	12	6	3.2(1.5)	none*	-10/+70

\* Reverse polarity unit can be used with external TC-3500 controller see P. 112

See also , "Power Supplies", P. 117

# AHP-150FF

## MOUNTING STYLE

Thru Mount

## ENVIRONMENTS

NEMA-12 IP 40 (maintains IP 52)

NEMA-4,4X IP 54

## RATING (TRADITIONAL)

100 BTU/hr @ 0 °F ΔT

123 BTU/hr @ +20 °F ΔT \*

## RATING (DIN 3168)

29 Watts L35 L35

21 Watts L35 L50

\* See page 10

## PERFORMANCE CURVE

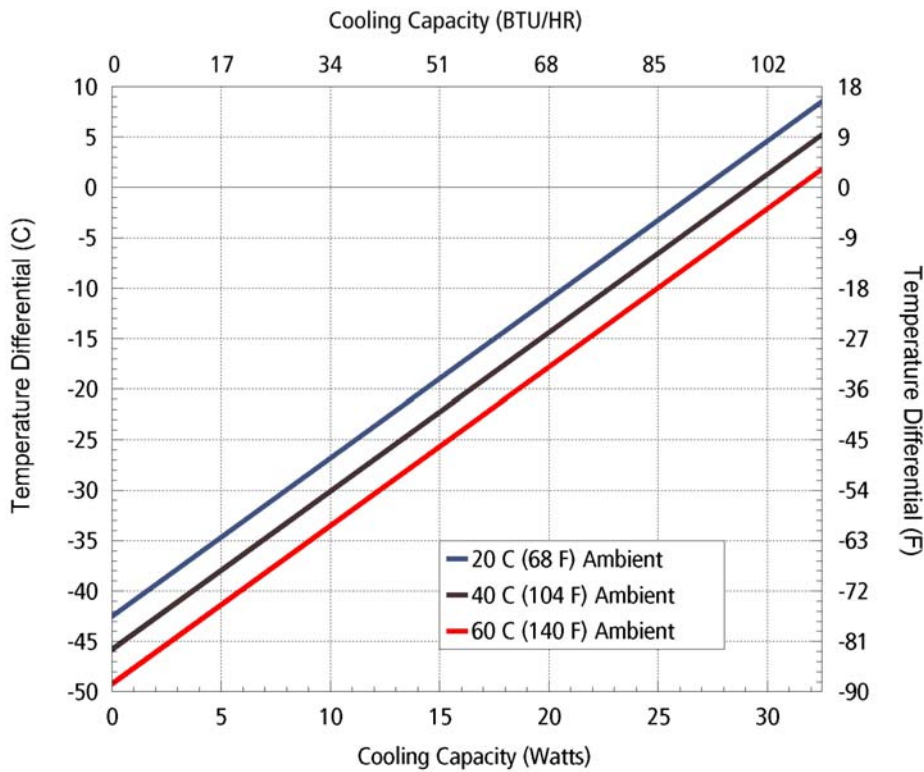

Equation of line: $y = \Delta T(^{\circ}C)$ $x = \text{Capacity (Watts)}$			
Ambient Temp	20°C	40°C	60°C
Enclosure Air	$y = 1.57x - 42.5$	$y = 1.57x - 45.8$	$y = 1.57x - 49.2$
Cold Sink	$y = 1.24x - 42.5$	$y = 1.24x - 45.8$	$y = 1.24x - 49.2$

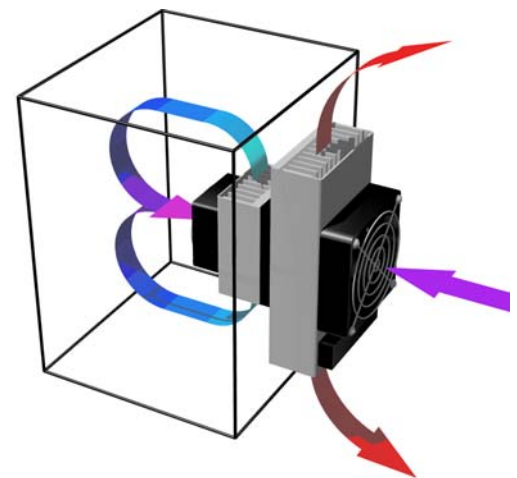

Air Flow Pattern

## DIMENSIONS

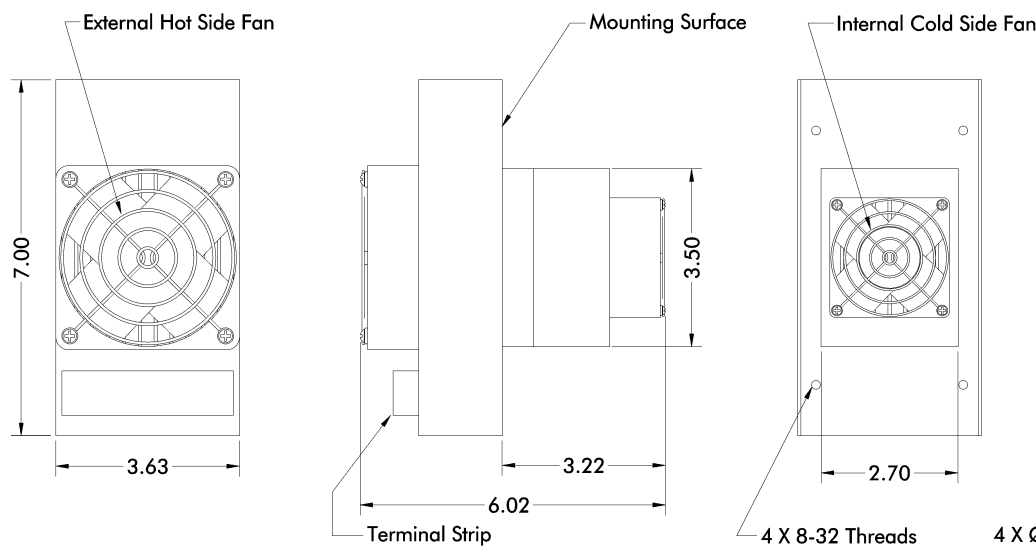

## MOUNTING CUTOUT DIMENSIONS

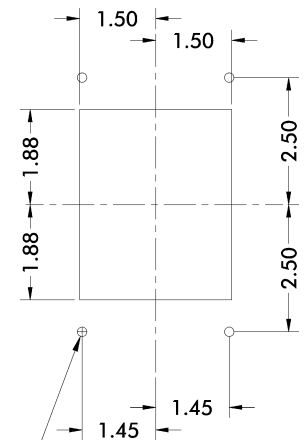

\* Dimension does not include hardware, insulation. Dimensions: Inches, Hardware and gasket included but not shown.